

KONWA[®]

KW-357

STEAMER WITH THREE VARIABLE TEMPERATURE CONTROL



INSTRUCTION MANUAL & PARTS LIST

PRODUCT DESCRIPTION

Application

The product is an appliance for ironing clothes and cleaning ironed textiles, which is widely used in clothing shops, marriage photographing and hotels.

Storage

Drain off water thoroughly from the appliance and pack it with a paper box when it is not in used.

Use After Storage

Check the steam pipe before use to see whether the inlet and outlet pipes have been blocked and whether the power line has been damaged. If there is block, please get rid of clogging before using it. And if there are damages in the power line, please contact professional personnel for maintenance and exchange.

Safety Protection Apparatus

1. Water Shortage Automatic Power- cut Protector
When water shortage happens in the steam generator, the protector will make hurried alarms like bee, bee, bee sounds, reminding to add water, and cut off the power to stop heating (It will automatically get the power back for normal function when water is added.)
2. Thermostat
When water shortage happens in the steam generator, the temperature of the steam generator will be controlled within the limited temperature range by the thermostat to effectively prevent dangers caused by high temperature in case of water shortage.
3. Microcomputer Temperature Control Protection (High sensibility)
The microcomputer controls the temperature range of the steam generator. The digital display screen indicates the current temperature and controls the preset highest temperature point. When the temperature reaches the highest point, the power will cut off to avoid dangers.
4. Thermal Fuse Cut Out
If the above two protection measures are out of function, the thermal fuse cut out will be in function. When the temperature of the steam generator reaches the thermal fuse cut out preset temperature, the thermal fuse cut out will be melted in time. Thus the power is out off and the dangers can be prevented.

Caution: Please do not use it any more if safety protection measures are damaged.

MAIN CHARACTERISTICS

1. The fashionable anti-slip pothook for the sprinkler can effectively prevent the sprinkler from falling to the ground caused by careless use.
2. The handle remote control steam regulator can regulate the steam volume according to the thickness of clothes at steam volume range from 1 to 3 grades. It is convenient to use and effective to save power.
3. The adjustable ironing appliance-supported pole can be rapidly and conveniently used and its height can be regulated according to the length of clothes and user's height.
4. The weaving heat isolation layer of the air vessel can prevent the air vessel overhead when it is used.
5. The digital display screen can evidently show the current power when the appliance is in function.
6. The microcomputer temperature control apparatus can control the temperature span of the steam generator.
7. The plug-in connection apparatus for the air vessel can be inserted by hand and turned it around from right to left. It is fast and has good seal capability without any gas and water leakage.
8. The polyurethane glide wheel has low noise and does not damage the ground by scratching when it is moving.
9. The steam filter anti-condensation apparatus can effectively control the temperature of the steam and effectively prevent condensed water leaking out and avoid the clothes from being wet.
10. When water shortage happens in the appliance, it will automatically cut off the power to the heating tube to effectively prevent the dry burning, while it can automatically get the power back to function itself when water is added.



ELECTRIC CIRCUIT DIAGRAM

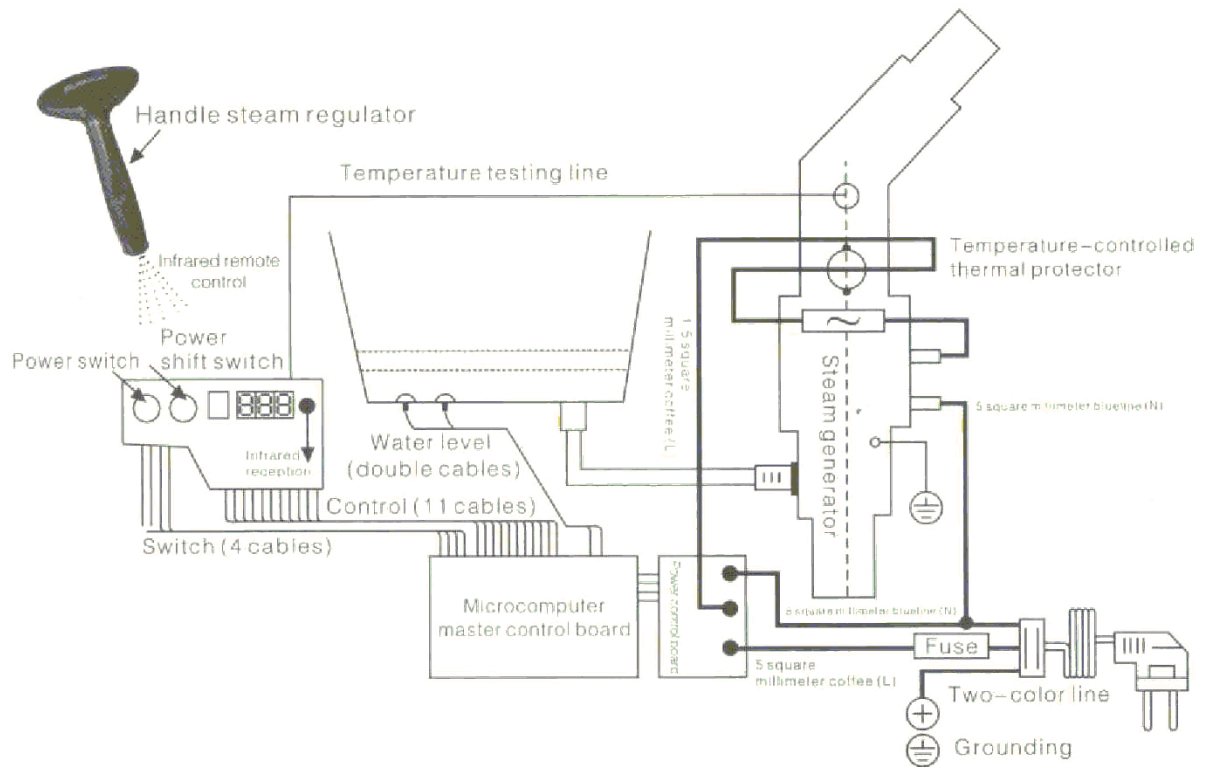

Main Technical Parameter :

Voltage	: 240V
Hertz	: 50Hz
Input Power	: 1700W
Water Storage Capacity	: 4.5 liter
Stored Water Continuously Generating Gas Time	: 3.0H
Rated Pressure	: 10000BA
Allowable Pressure	: 80000BA
Rated Evaporation Rate	: 20ml / min
Vaporization Temperature At The Outlet	: 98°C
Noise	: <60dbc(A)
The Highest Point Of The Supporting Pole	: 1750mm
The Lowest Point Of The Supporting Pole	: 980mm
The Adjustable Height Of The Upper Pole	: 850mm
The Extension Length Of The Air Tube	: 1600mm
Gross Weight	: 6.8kg
Net Weight	: 5.5kg
Packing Size	: 455 x 368 x 455mm

DIAGRAM

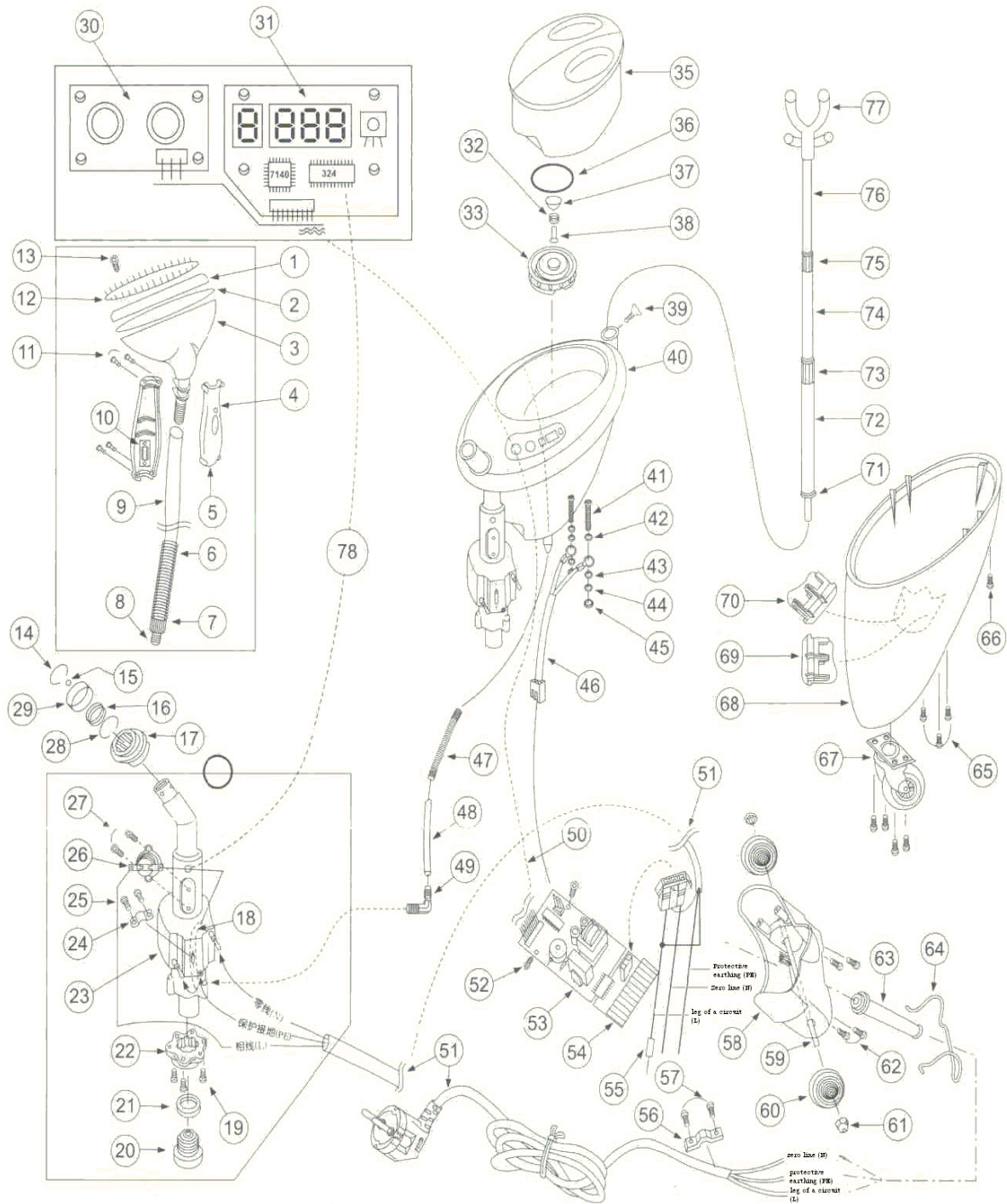

Accessories Diagram	
1	Lid for steam sprinkler
2	Seal loop for the sprinkler lid
3	Sprinkler
4	Steam regulator
5	Handle of the steam sprinkler
6	Spring of the protection pipe
7	Casing of the joint for steam pipe
8	Joint of the steam pipe
9	Plastic steam pipe
10	Remote control projection panel
11	Bolt M3x16
12	Brush
13	Screw M4x12
14	Upper circlet
15	Stainless steel ball o.3MM
16	Slipping spring in the casing
17	Upper heat insulated casing
18	Heat protector 250 degree
19	Screw M4x16
20	Water-proof screw
21	High temperature resistance silica gel tray
22	Lower heat insulated fixed casing
23	Steam generator
24	Clamp plate for heat protector
25	Bolt M3x6
26	Temperature controller
27	Bolt M3x6
28	Lower circlet
29	Movable casing
30	Switch circuit board
31	Digital display board
32	Spring of the lid for water tank
33	Lid of the water tank
34	-
35	Water tank
36	Seal stray for the lid of the water tank
37	V-shape stray for the lid of the water tank
38	Slipping pole for the lid of the water tank
39	Fixed screw for the hanging ironing pole

Accessories Diagram	
40	Upper hull
41	Water level indication screw
42	Water level seal loop
43	Stray
44	Spring stray
45	Screw cap 4mm
46	Water level indication wire
47	Bending resistance spring
48	Small leather pipe
49	Water inlet joint
50	11-wire drop-out line
51	Power bus
52	Bolt M3x7
53	Microcomputer operated control main board
54	Power output control board
55	Fuse
56	Clamp plate for the bus
57	Bolt M3x7
58	Base hull
59	Axle
60	Polyurethane glide wheel
61	Axle screw cap
62	Bolt M4x18
63	Protective casing of the bus
64	Steel wire loop
65	Bolt M4x18
66	Bolt M4x16
67	Polyurethane universal wheel
68	Lower hull
69	Integrated block (right)
70	Integrated block (left)
71	Fixed pole of the hanging ironing bar
72	Lower pole
73	Protective casing of the lower pole
74	Middle pole
75	Protective casing of the middle pole
76	Upper pole
77	Pothook for hanging the sprinkler
78	Temperature measurement line

TROUBLESHOOTING

Phenomenon	Reason	Solution
Not function at all	Is the power plug plugged? Is there any trouble with the circuit? Is the fuse cut out burn off?	Contact professional personnel to repair.
A small volume of steam	Do deposits block the pipe? Is the voltage too low?	Clean the deposits away with the cleanser. Suggest installing the Monistat.
Hot steam generated in the water tank	Does deposits or other substance block the pipe? The air vessel is bent or fumaroles are blocked?	Clean away deposits or the blocked substance. Let the air vessel direct and do not close the air outlet.
Steamed water leakage happens at the connection place of the steam circuit	Is the seal loop aging? Is there loose between the air vessel and the pipe joint?	Replace the seal loop. Get the joint of the air vessel tight.
Water leakage happens in the sprinkler	Is the sprinkler broke?	Replace the sprinkler.
The inner of the air vessel makes noise	Is the air vessel bent? The sprinkler is below the horizontal line at ironing?	Unbend the air vessel to get the sprinkler higher.
The water tank is deformed	Is super hot water added in?	Continue using the water tank or replace it.
The flex hanging ironing pole is pulled out	Operate it without following the regulations?	Continuously insert it in.
There is no steam at the setup, but the power indication will display	The steam generator is burned down, or inadequate contact happens because of the loosing of the plug in the temperature line, or the temperature probe is broken?	Contact professional personnel to check.
Alarm arises when water level is normal or no alarm when water level is abnormal	There is dirt on water level indication screw in the water bucket or there are too many deposits?	Clean the water level indication screw.

SAFETY PRECAUTIONS

- Do not use the product if you have not carefully read the user's manual.
- You would better use the 30MA power resource equipped with the electricity leakage protection switch when you are using this product.
- Do not use the product during checking.
- Please unplug the power plug during the maintenance.
- Do not use the product if the parts of the product are damaged, especially the safety protection apparatuses and the power line.
- Do not try to repair the damaged structure of the product by yourself. You should contact professional personnel to repair it because the improper maintenance will cause electricity leakage and accidents.
- Do not dismantle safety apparatuses by yourself because that will cause dangers.
- Do not unplug the plug at a way of pulling. The proper way is to unplug it by holding the head of the plug.
- Do not put the product in water or other liquids to avoid electricity leakage.
- When the product is in use, do not walk away, and do not let children touch it and do not touch the heater. Pay attention not to be scalded by hot water when pour out remaining water from the steamer.
- When the sprinkler of the air vessel is unplugged at a high temperature state, please hold the heat insulated part to avoid being scalded.
- Do not bend the air vessel or block the air outlet because that will cause accidents resulting from high air pressure.
- Do not add hot water into the water tank, or the water tank will be deformed.
- If air or water leakage happens in the steam generator, please stop it promptly and contact professional personnel to maintain it.
- Let the products naturally cool down after using it.
- Please unplug the power plug when the product is not in use.
- Please do not add the cleanser into the water tank.

KONWA®

KONWA INDUSTRIAL SEWING MACHINE (M) SDN BHD (124740-M)

Head Office: Lot 11 & 13, Jalan 51/201, Off Jalan Tandang, Seksyen 51, 46050 Petaling Jaya,
Selangor Darul Ehsan, Malaysia.

Tel: +603-7788 1111

Fax: +603-7788 5555

E-mail: konwa@konwa.com.my URL: www.konwa.com.my